

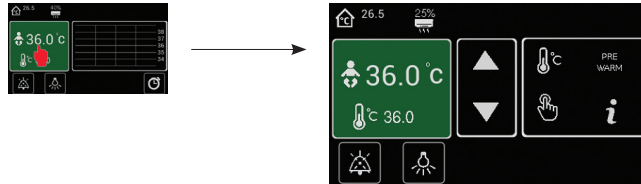

Refer to User Manual for comprehensive information:  
<http://www.mttts-asia.com/wallaby-warmer/>

## Modes of operation

Touch MODE Selection panel to enter MODE Selection screen



### BABY MODE

Set temperature: 34°C - 37.5°C

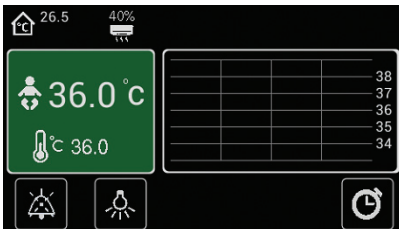

In BABY MODE, the warmer provides stable control of the baby's skin temperature by automatically adjusting the heater power to compensate for varying physiological and environmental conditions.

### PREWARM MODE

Set temperature: not available

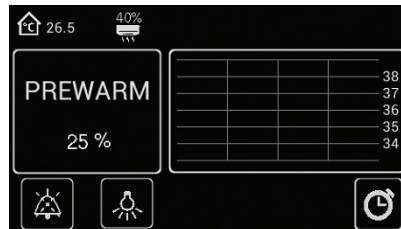

In PREWARM MODE, the warmer provides general alarm free pre-warming of the heater and environment above the warmer mattress.

### MANUAL MODE

Set heater power: 0-100%

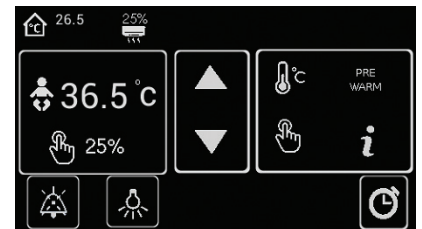

In MANUAL MODE, the warmer provides user-adjustable heater power and the option to monitor the baby's skin temperature using skin sensor.



If the patient skin temperature is more than 1°C above the set point, then the heater is OFF and the output value displayed is 0 (zero).

## Timers

### APGAR

Alarm at 1, 5 and 10 minutes. Switches off after 60 minutes.

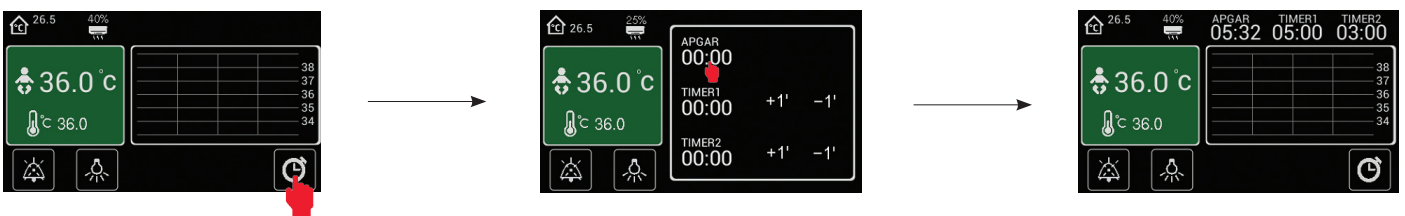



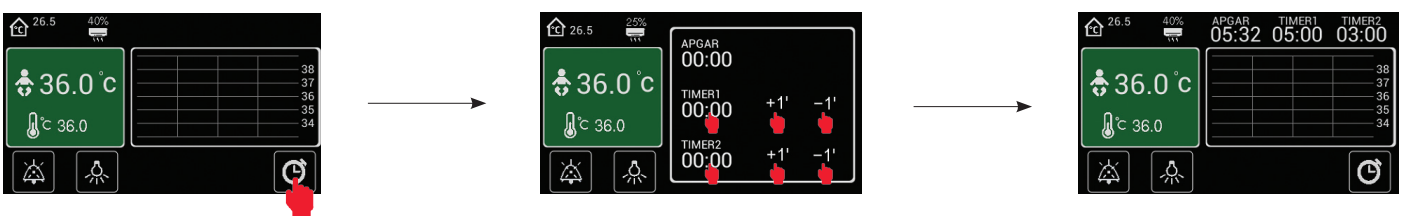

### PROCEDURE TIMERS

Alarm at the end of preset period from 1 to 99 minutes.

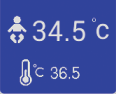

## Alarms

| Alarm                                                                                                         | Mode    | Cause                                                                                      | Effect                         | Mute Button                             |
|---------------------------------------------------------------------------------------------------------------|---------|--------------------------------------------------------------------------------------------|--------------------------------|-----------------------------------------|
| <b>HIGH SKIN TEMP</b><br>    | BABY    | Measured skin temperature higher than set temperature by 1°C                               | Heater power disabled          | Silences audible alarm only             |
|                                                                                                               | MANUAL  | Measured skin temperature higher 38°C                                                      | Heater power disabled          | Silences audible alarm only             |
|                                                                                                               | PREWARM | Not active                                                                                 | Not active                     | Not active                              |
| <b>LOW SKIN TEMP</b><br>     | BABY    | Measured skin temperature lower than set temperature by 1°C                                | Heater reduced to 25% of power | Cancels alarm and restores heater power |
|                                                                                                               | MANUAL  | Not active                                                                                 | Not active                     | Not active                              |
|                                                                                                               | PREWARM | Not active                                                                                 | Not active                     | Not active                              |
| <b>SENSOR DISCONNECT</b><br> | BABY    | Skin sensor unplugged or faulty                                                            | Heater reduced to 25% of power | Silences audible alarm only             |
|                                                                                                               | MANUAL  | Not active                                                                                 | Not active                     | Not active                              |
|                                                                                                               | PREWARM | Not active                                                                                 | Not active                     | Not active                              |
| <b>POWER FAILURE</b><br>     | ALL     | Power supply to Warmer failed                                                              | Warmer disabled                | Silences audible alarm only             |
| <b>ERROR</b><br>           | ALL     | Software or hardware failure (refer to Service Manual for more information on error codes) | Warmer disabled                | Silences audible alarm only             |



When available, the mute alarm period is 10 min.

## X-ray procedure

1. Turn the main switch of the device off and silence the power failure alarm
2. Wait until the device cools down
3. Lift the overhead unit up
4. Move overhead unit left or right
5. After X-ray procedure is completed return the overhead unit to center position
6. Make sure the overhead unit is locked in center position
7. Turn the device on

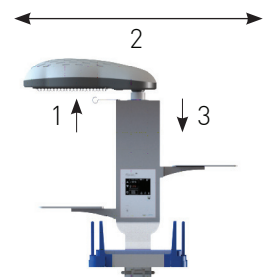

## Turning off the Warmer

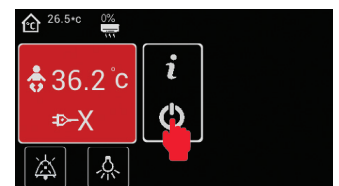
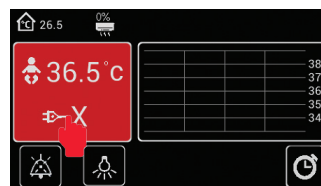

The action will activate POWER FAILURE alarm.

Press and hold the OFF symbol for 3 seconds